

# DESA Overall Coverage Report by Channel



**Surveyor:** Paul Luther

**Location:** Head Office Australia

**Survey Description:**

Example survey of Head Office. Testing equipment included Proxim ORiNOCO 4000 and ORiNOCO 700 series Access Points utilising the internal antenna on channel 52 and 56. All data was captured with a Cisco AirMagnet Aironet 802.11 a/b/g Wireless Adaptor AIR-CB21AG-A-K9.

**Time of Survey:** 9/02/2006 12:10:13 PM

## Contents

- Access Points Information
- Signal Distribution
- Noise Distribution
- Signal/Noise Distribution
- Maximum Speed Distribution
- Retry Rate Distribution
- Loss Rate Distribution

## Access Points

<u>AP Name</u>	<u>Media Type</u>	<u>Mac Address</u>	<u>Channel</u>	<u>SSID</u>	<u>Power, mw</u>	<u>Max Signal</u>
Non ACL, Neighborings, Rogues						
Proxim:5A:3E:71	802.11a	00:20:A6:5A:3E:71	52	DESA	100	-44
Proxim:59:CB:EB	802.11a	00:20:A6:59:CB:EB	56	DESA	100	-38
<b># of AP</b>	<b>2</b>					
<b>Total AP:</b>	<b>2</b>					



# Individual Signal Distribution

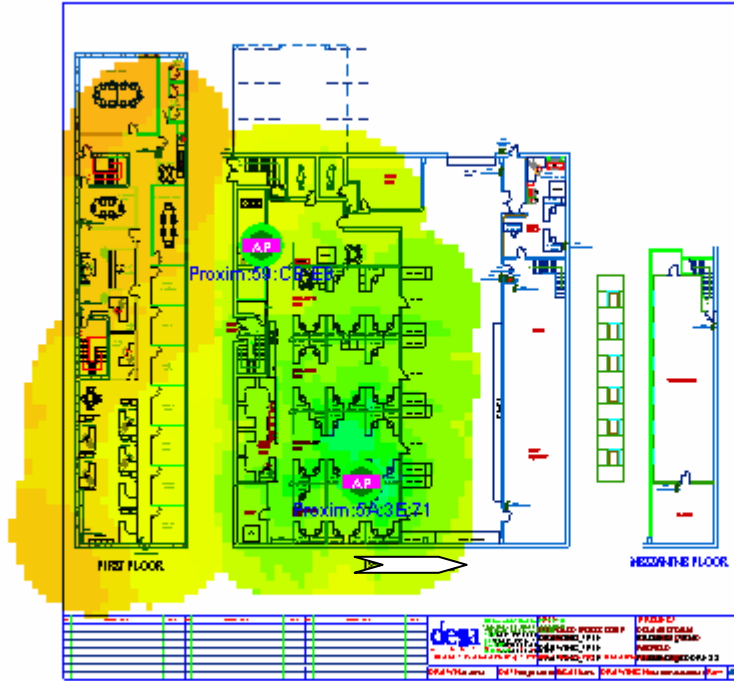

Channel 52

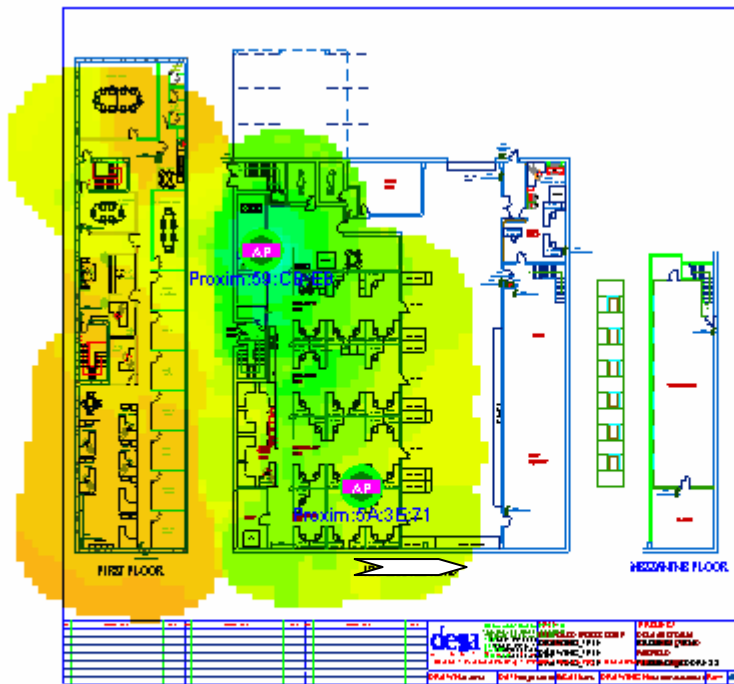

Channel 56



# Noise Distribution

= 6.82 m

Dimensions (X x Y): 120.00 m x 120.00 m

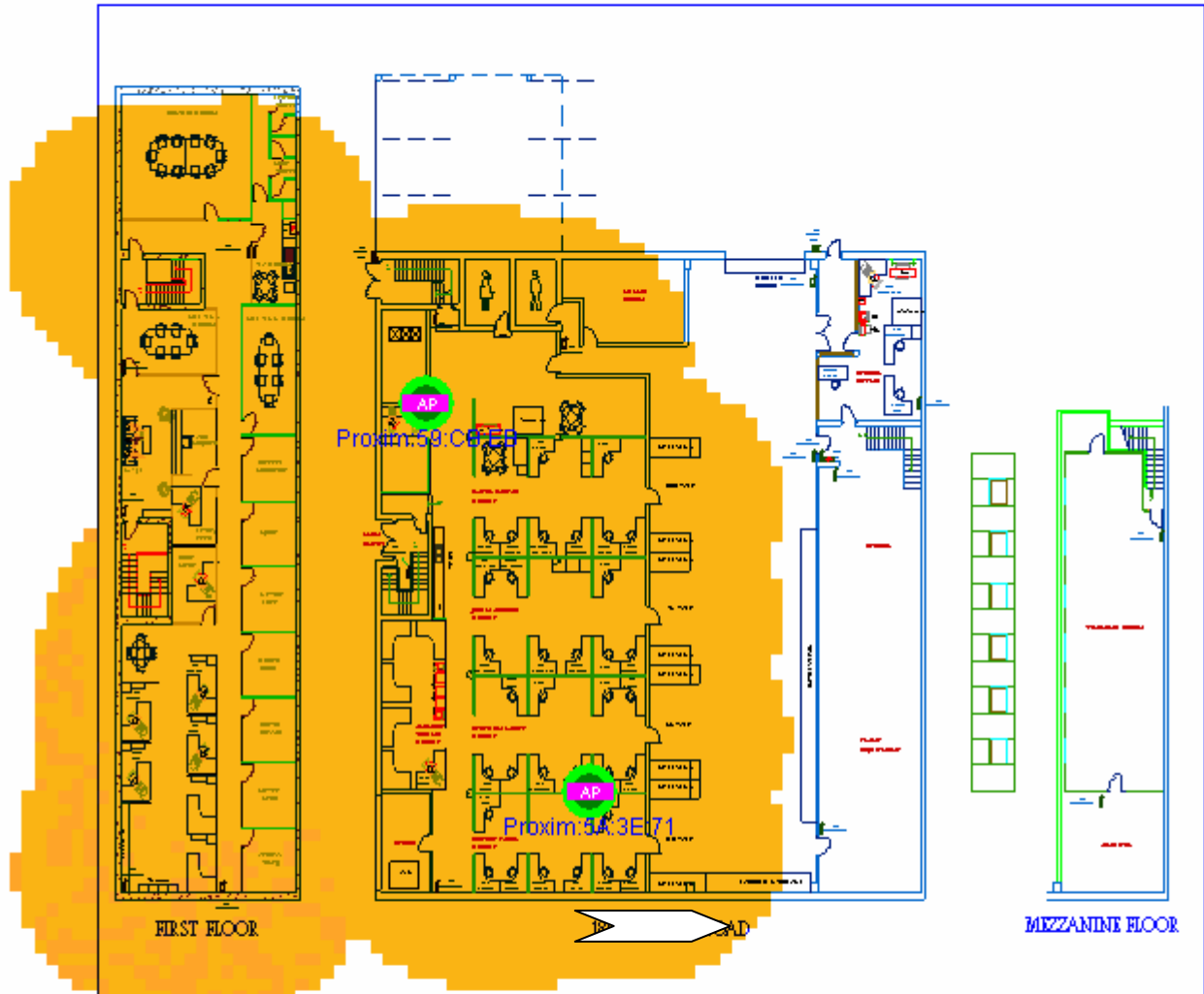

NO	DESCRIPTION	DATE	BY	DESCRIPTION	DATE	BY	DESCRIPTION	DATE

	DESA AUSTRALIA PTY LTD 100 George Street, Sydney NSW 2000 Australia Phone: +61 (0)2 9230 9999 Email: sales@desa.com.au Website: www.desa.com.au Desig - Marketing - Proj - Sales	PROJECT: DESA AUSTRALIA PROPOSED WORKGROUP DRAWING_TITLE DRAWING_TITLE DRAWING_TITLE DRAWING_TITLE	PROJECT: DESA AUSTRALIA PROPOSED WORKGROUP DRAWING_TITLE DRAWING_TITLE DRAWING_TITLE DRAWING_TITLE
DRAWING NO:	DATE:	SCALE:	DRAWING NO:



# Individual Noise Distribution

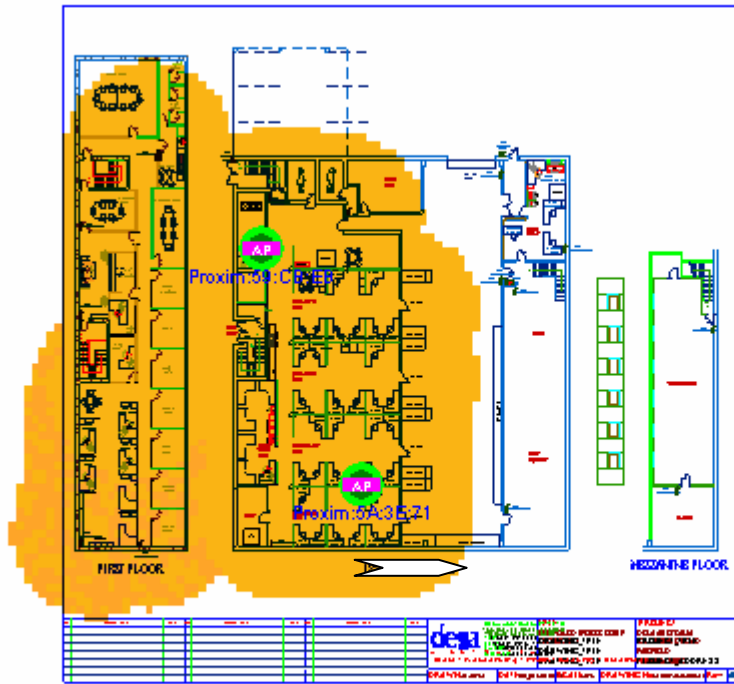

Channel 52

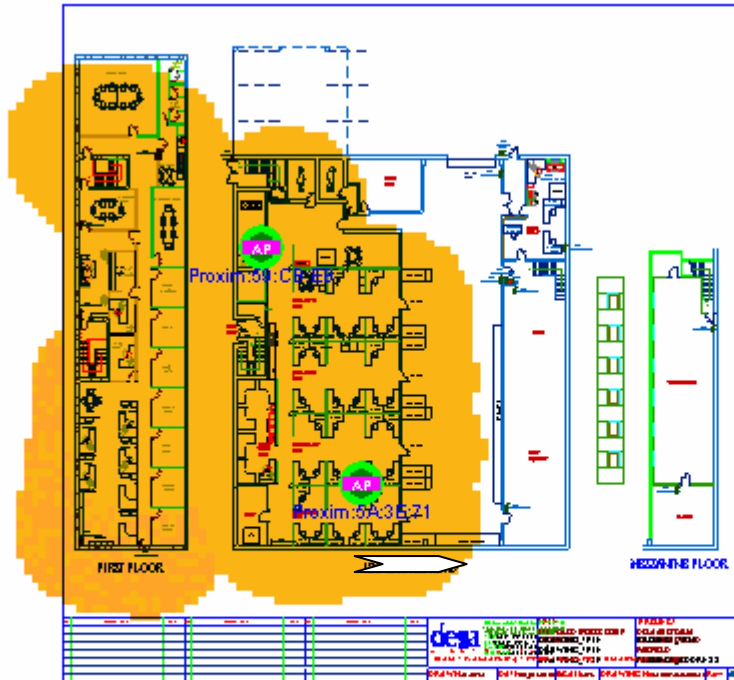

Channel 56



# Signal/Noise Distribution

= 6.82 m

Dimensions (X x Y): 120.00 m x 120.00 m

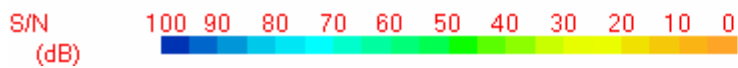
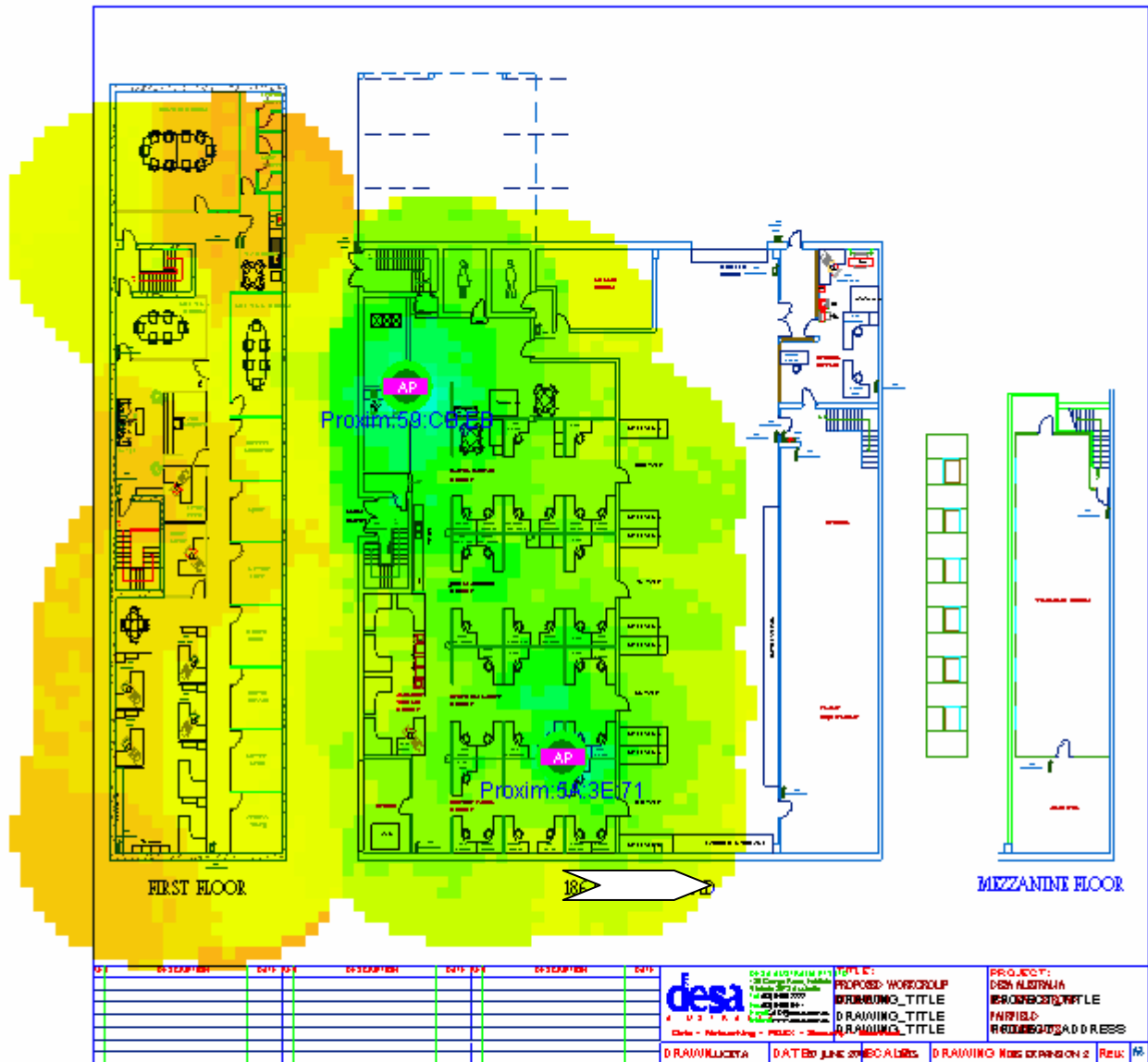

# Individual S/N Distribution

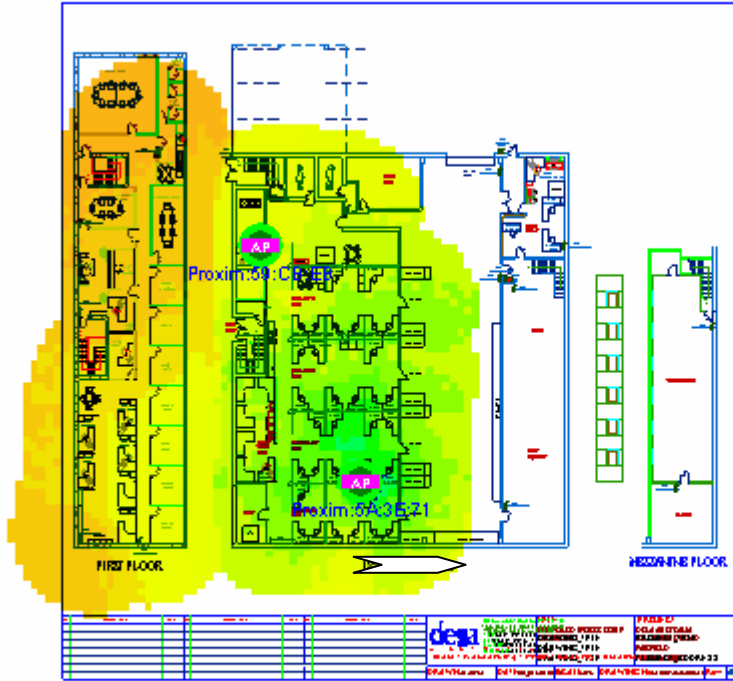

Channel 52

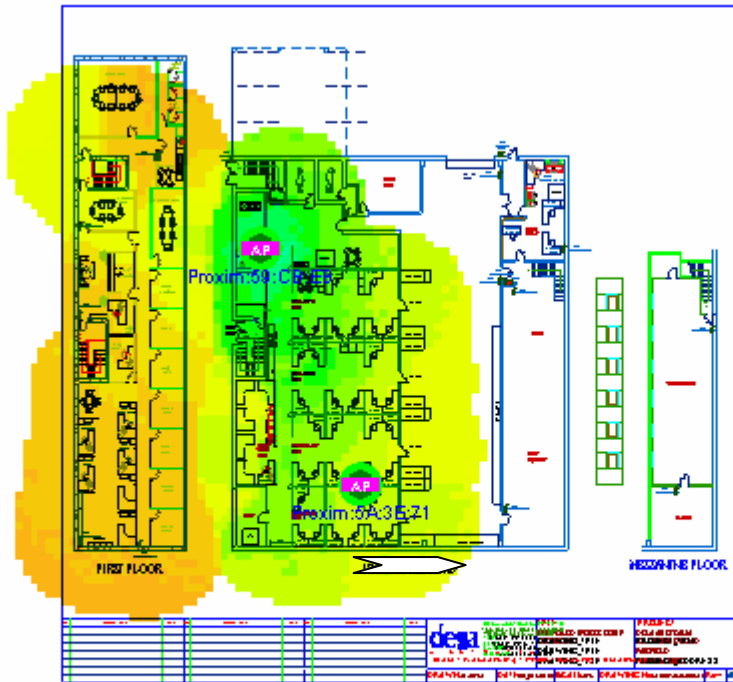

Channel 56

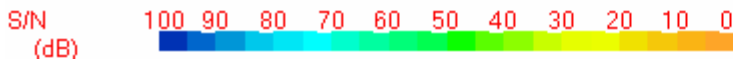

# Maximum Speed Distribution

Overall Coverage Report by Channel

= 6.82 m

Dimensions (X x Y): 120.00 m x 120.00 m

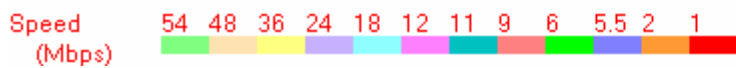
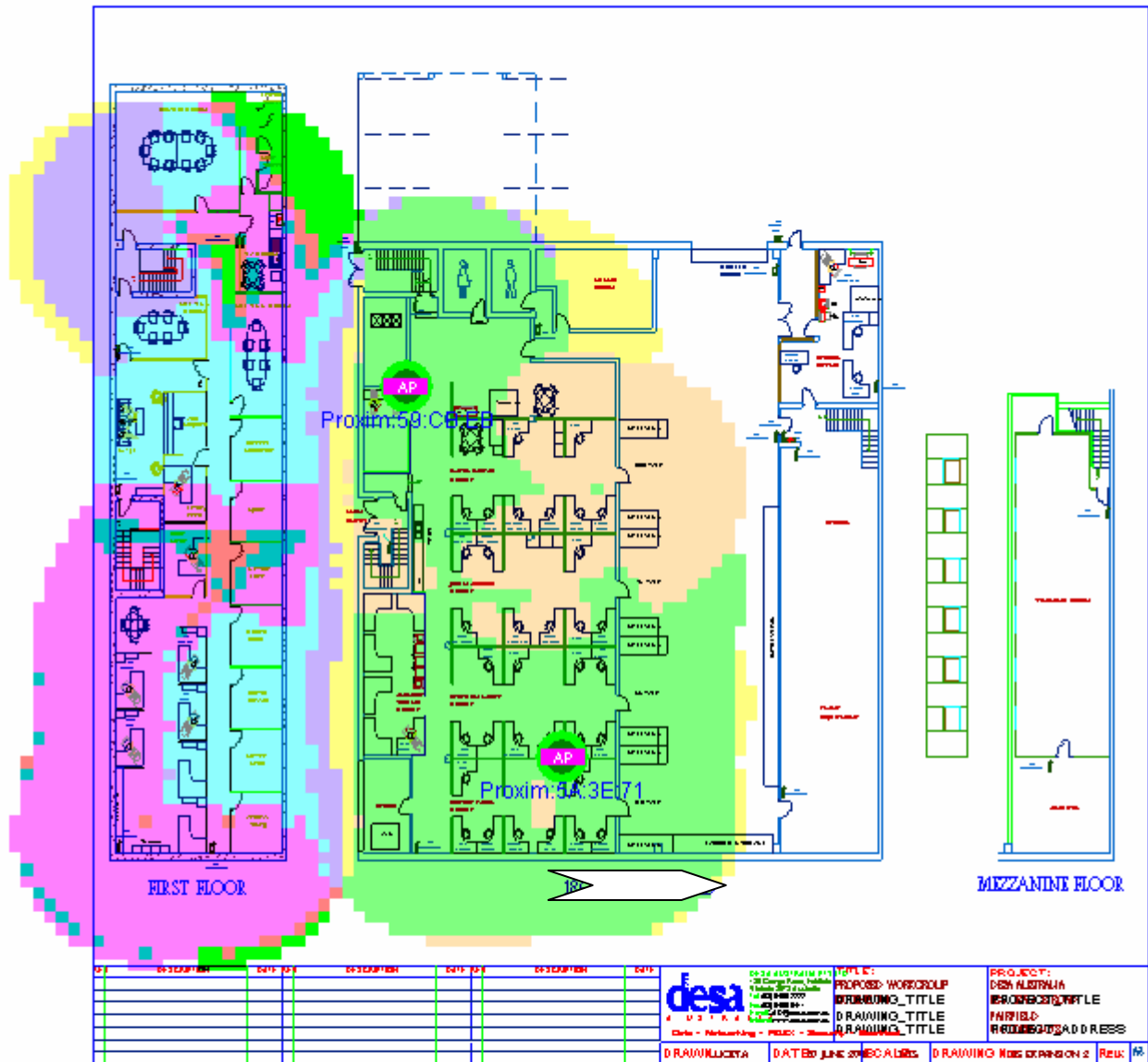

# Individual Speed Distribution

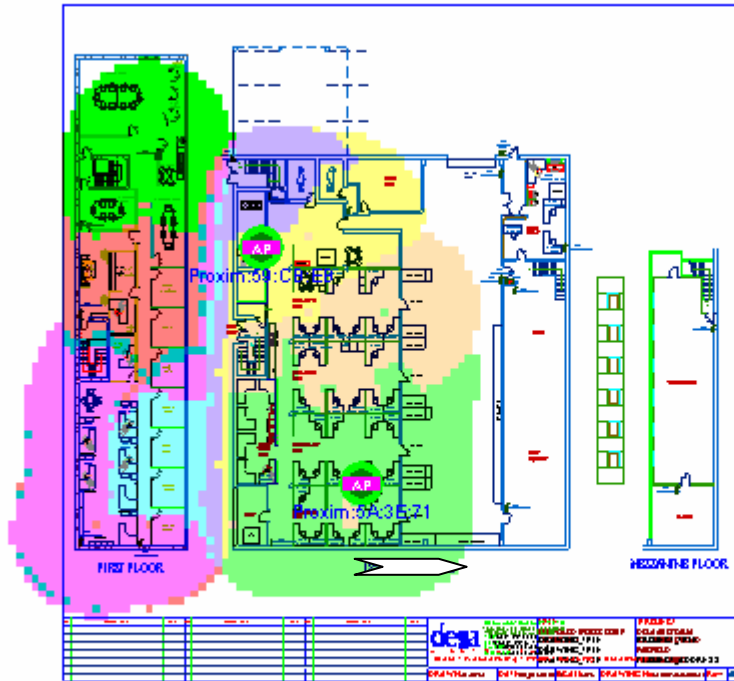

Channel 52

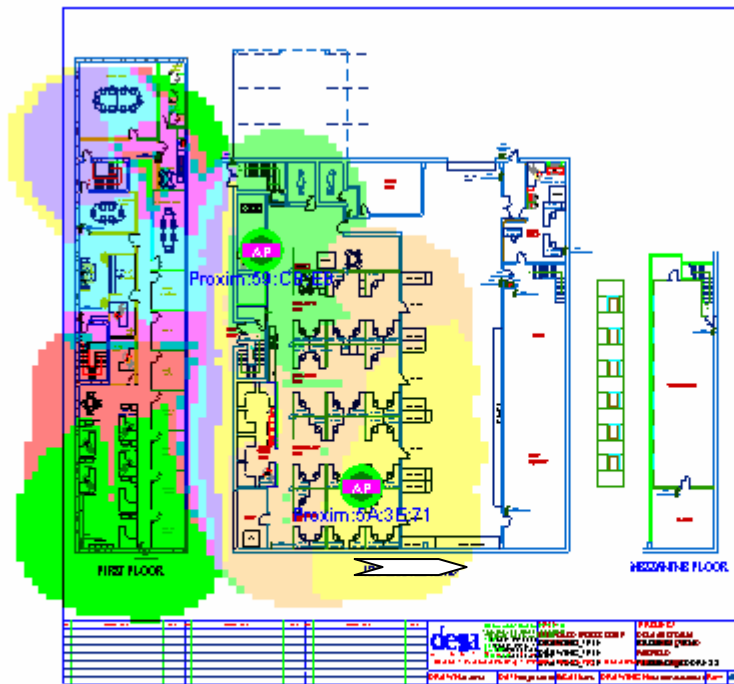

Channel 56

